

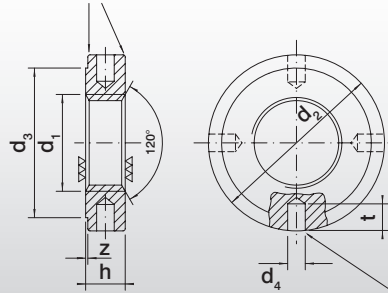

DIN 1816

Kanten gebrochen / chamfered edges

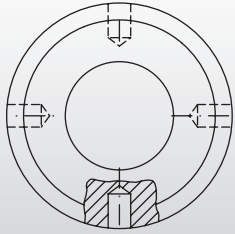

Kanten gebrochen / chamfered edges

Abmessungen / dimensions in mm

Bezeichnung / Description	Gewinde d_1 / Thread d_1	d_2	d_3	d_4	h	t	z	Löcher	kg / 1000
DIN 1816 M 6	M 6 x 0,75	16	12	2,5	5	4,0	0,5	4	0,595
DIN 1816 M 8	M 8 x 1,00	20	16	2,5	5	4,5	0,5	4	0,950
DIN 1816 M 10	M 10 x 1,00	25	20	3,0	6	4,5	0,5	4	1,810
DIN 1816 M 12	M 12 x 1,50	28	23	3,0	6	5,0	0,5	4	2,230
DIN 1816 M 14	M 14 x 1,50	30	25	4,0	7	5,0	0,5	4	2,880
DIN 1816 M 16	M 16 x 1,50	32	27	4,0	7	6,0	0,5	4	3,120
DIN 1816 M 18	M 18 x 1,50	34	28	4,0	8	6,0	0,5	4	3,920
DIN 1816 M 20	M 20 x 1,50	36	30	4,0	8	6,0	0,5	4	4,250
DIN 1816 M 22	M 22 x 1,50	40	34	4,0	9	6,0	0,5	4	6,050
DIN 1816 M 24	M 24 x 1,50	42	36	4,0	9	6,0	0,5	4	6,450
DIN 1816 M 26	M 26 x 1,50	45	38	5,0	10	6,0	0,5	4	8,100
DIN 1816 M 28	M 28 x 1,50	50	43	5,0	10	7,0	0,5	4	10,300
DIN 1816 M 30	M 30 x 1,50	50	43	5,0	10	7,0	0,5	4	9,550
DIN 1816 M 32	M 32 x 1,50	52	45	5,0	11	7,0	0,5	4	11,100
DIN 1816 M 35	M 35 x 1,50	55	48	5,0	11	7,0	0,5	4	12,000
DIN 1816 M 38	M 38 x 1,50	58	50	5,0	11	8,0	0,5	4	12,700
DIN 1816 M 40	M 40 x 1,50	62	54	6,0	12	8,0	0,5	4	16,200
DIN 1816 M 42	M 42 x 1,50	62	54	6,0	12	8,0	0,5	4	15,000
DIN 1816 M 45	M 45 x 1,50	68	60	6,0	12	8,0	0,5	6	18,500
DIN 1816 M 48	M 48 x 1,50	75	67	6,0	13	10,0	0,5	6	25,600
DIN 1816 M 50	M 50 x 1,50	75	67	6,0	13	10,0	0,5	6	24,100
DIN 1816 M 52	M 52 x 1,50	80	70	6,0	13	10,0	0,5	6	28,600
DIN 1816 M 55	M 55 x 1,50	80	70	6,0	13	10,0	0,5	6	26,100
DIN 1816 M 58	M 58 x 1,50	90	80	6,0	13	10,0	0,5	6	37,000
DIN 1816 M 60	M 60 x 1,50	90	80	6,0	13	10,0	0,5	6	35,100
DIN 1816 M 62	M 62 x 1,50	95	85	6,0	14	12,0	0,5	6	42,300
DIN 1816 M 65	M 65 x 1,50	95	85	8,0	14	12,0	0,5	6	39,200
DIN 1816 M 68	M 68 x 1,50	100	90	8,0	14	12,0	0,5	6	44,000
DIN 1816 M 70	M 70 x 1,50	100	90	8,0	14	12,0	0,5	6	41,500
DIN 1816 M 72	M 72 x 1,50	110	100	8,0	14	12,0	0,5	6	57,400
DIN 1816 M 75	M 75 x 1,50	110	100	8,0	14	12,0	0,5	6	53,600
DIN 1816 M 80	M 80 x 2,00	115	105	8,0	16	12,0	1,0	6	57,500
DIN 1816 M 85	M 85 x 2,00	120	110	8,0	16	12,0	1,0	6	68,000
DIN 1816 M 90	M 90 x 2,00	130	120	8,0	16	12,0	1,0	6	84,300
DIN 1816 M 95	M 95 x 2,00	135	120	8,0	16	12,0	1,0	6	87,500
DIN 1816 M 100	M 100 x 2,00	145	130	8,0	16	12,0	1,0	6	106,000