

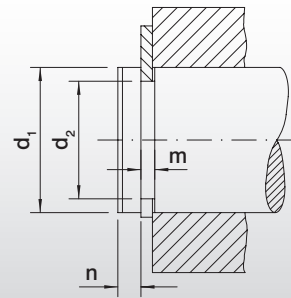

DIN 6799 RA

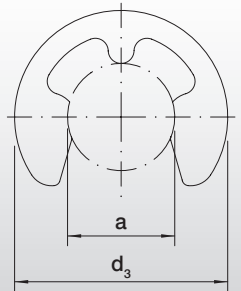

Ringabmessungen/ring dimensions in mm

Bezeichnung/ Description	d_2	d_1	s	a	d_3 max	kg/1000
RA 1,2	1,2	$1,4 \leq d_1 \leq 2$	0,30	1,01	3,25	0,007
RA 1,5	1,5	$2 \leq d_1 \leq 2,5$	0,40	1,28	4,25	0,019
RA 1,9	1,9	$2,5 \leq d_1 \leq 3$	0,50	1,61	4,80	0,040
RA 2,3	2,3	$3 \leq d_1 \leq 4$	0,60	1,94	6,36	0,060
RA 3,2	3,2	$4 \leq d_1 \leq 5$	0,60	2,70	7,30	0,075
RA 4,0	4,0	$5 \leq d_1 \leq 7$	0,70	3,34	9,30	0,158
RA 5,0	5,0	$6 \leq d_1 \leq 8$	0,70	4,11	11,30	0,215
RA 6,0	6,0	$7 \leq d_1 \leq 9$	0,70	5,26	12,30	0,230
RA 7,0	7,0	$8 \leq d_1 \leq 11$	0,90	5,84	14,30	0,416
RA 8,0	8,0	$9 \leq d_1 \leq 12$	1,00	6,52	16,30	0,613
RA 9,0	9,0	$10 \leq d_1 \leq 14$	1,10	7,36	18,80	0,905
RA 10,0	10,0	$11 \leq d_1 \leq 15$	1,20	8,32	20,40	1,140
RA 12,0	12,0	$13 \leq d_1 \leq 18$	1,30	10,45	23,40	1,770
RA 15,0	15,0	$16 \leq d_1 \leq 24$	1,50	12,61	29,40	3,370
RA 19,0	19,0	$20 \leq d_1 \leq 31$	1,75	15,92	37,60	6,420
RA 24,0	24,0	$25 \leq d_1 \leq 28$	2,00	21,88	44,60	8,150
RA 30,0	30,0	$32 \leq d_1 \leq 42$	2,50	25,80	52,60	12,500